



*live  
afresh*

**SIDDHA**  
SIDDHAPINES  
P&S  
P.O. NO. 1, 2018

Siddha Park - P&S Park Street - Kulkarni, PUNE-411 007 (INDIA) - P. NO. 00 2227 4111  
Rajawade Park Road - 211 Bld. House - Opposite Dnyanesh College - Kulkarni, PUNE-411 008 - P. NO. 00 2578897 - F. NO. 00 2578878  
E. marketing@siddhagroup.com - W. siddhagroup.com

SIDDHA  
PINES

[www.Zricks.com](http://www.Zricks.com)



[www.Zricks.com](http://www.Zricks.com)





Four tranquil towns:  
Aspen, Birch, Cypress and Silver.

Situated far from the bustle  
of the city, yet near enough

to the business and  
entertainment pulse of the city.

The tallest in the  
Eggarhart main road area.

*Your abode of peace*

Life is all about making up the  
bedside and making ahead with the  
town. Make it better than ever.  
Built on acres of sprawling  
landscaped greenery and beautiful  
main road. There is no time to  
countdown happy families.

With the wind whispering through  
the pines and the softest  
fragrance of the blossoms, you  
will find life at Silver Pines as  
complete, that you would never  
want to leave home.



[www.Zricks.com](http://www.Zricks.com)



ZRICKS

## Well Connected

Thanks to a **Quality Place**, it's all in the name of the **Omaha Gateway**, the planned, air-conditioned and air-purified transit station with **24/7** transit, information kiosk, computerized ticket, books, snacks, school, hospital, bank, **WiFi** office and a market with easy walking distance. It's just a matter of time.

Well connected too, **Quality Place** is close to the existing **Metropolitan Expressway** and other major highways, which links it to the **Omaha** and the **National Highway**. The station is close to **land** and several modes of public transport are also easily available.

Go further. **Quality Place** bridges connectivity with **quality**.



ZRICKS

The towers will have

1,3/4 BRK apartments.

Modern security management

and fire protection systems.

A network of intercoms, cable TV,

broadband connection and other

state-of-the-art amenities.

# Quality of Life

The extensive pool and fitness club will cater and round a healthy lifestyle.

The towers are located in an exclusive landscaped residential area with its own central roads. Landscaped grounds, walkways and play areas will provide a healthy lifestyle and recreation amenities for all residents.

The apartments are open plan, fully furnished and well lit.

[www.Zricks.com](http://www.Zricks.com)

## Amenities

Embark Point, Well-Decorated Lobby

Progress Park, Landscaped Green Area

Market Village, Residents' Club

Pine Apple, Color Club

Lily Pond, Swimming Pool

Trees Care, Health Club

Powerhouse, Gymnasium

Bookery Library

Loose & Beadles, Large Air-Conditioned  
Resident Hall connected with the Lobby

Swedish, Indoor and Outdoor games

Fun & Fables, Children's Play Area

Hub Hub, Great Air-Conditioned  
Resident Hall connected  
with the Lobby

Shuttle up, Badminton Court

Real Mantra, Yoga Room

Winkery Bookery, Toddler's Zone

Tumble Toys, Cinema

White Space, Chess Zone



## Facilities

State-of-the-art Fire Fighting System

Intercom Network

Cable TV and Broadband

History Car Parking Area

Sewage Treatment Plant

Rain Water Harvesting System

Power Backup—Generators

Water Filtration Plant

24 Hours Water Supply

Elevators

Dedicated Provision Store

View Leaflet Here

# Proposed Specifications



## Structure

Earthquake resistant (EC) framed construction with reinforced walls.

## Internal Walls

Concrete plastering overlaid with smooth, impervious plaster of paris.

## Doors

Heavy solid-wood timber frames and solid-core flush doors.

## Windows

Aluminium frames with fully glazed windows and superior quality fittings.

## Flooring

Marble tile flooring in all bedrooms, living dining areas and common areas.

## Kitchen

Flow-Through-Ceramic tiles, Counter Top Granite with stainless steel kitchen sink and stainless steel breakers, TV socket and broadband connection.

## Water

Flow-Ceramic tile flooring, Double-Ceramic tiles up to a height of 7 feet.

## Sanitary ware

White, high quality porcelain fittings of Porcelanox or equivalent, Chromium plated fittings of copper or stainless steel. Super joints in all bathrooms and one meeting another joint.

## Electricals

Superior quality concealed copper wiring with the latest modular switches and miniature circuit breakers, TV socket and broadband connection.

## Telephone Wiring

Central distribution box at ground floor with a network of 16 built-in telephone wiring in each apartment, with provision for socket points in the master bedroom and other areas of the apartment.

## Exterior

Latest weatherproof rain falling exterior finish of the highest quality.

# Siddha Projects

## Kolkata

- Started 1993
- Premium Residential Complexes
- Modern Commercial Highrises

## Jaipur

- Started 1988
- Premium Residential Complexes
- Most sought after Commercial Hubs
- Large format Townships
- Crown Jewel (Raj) Aangan

## WV Township

Spread Over 123 acres with 90% luxury Bungalows, in association with the Rajasthan Housing Board



### Siddha Park

101 Park Street, Kolkata (West)

One commercial complex with office modern architectural features and facilities



### Siddha Point

101 Park Street, Kolkata (West)

A sophisticated office complex with good modern architectural features



### Raj Aangan

Sector 12, Kumbha Marg, Pratik Nagar, Jaipur (West), Rajasthan

Township in a peaceful neighbourhood



### Kamada

Agarwal Main Road (on the Road) Near Saraswati College, Kolkata (West)

New age studio apartments situated near IT & Electronic hub



### Siddha Fifth Avenue

Block Industrial Zone Behind Holy General Hospital, Kolkata (West)

One modern commercial complex with state-of-the-art facilities



### Siddha Town

101 Park Street, Kolkata (West)

High residential project with commercial space

### Siddha Regal

101 Park Street, Kolkata (West)

The epitome of magnificence. Residential project in an upscale locality



### Our Architects

Agrowal & Agrowal, Kolkata and Ranchi, have established their own style in producing highly innovative, aesthetic and functional designs for both residential and commercial complexes.

Besides designing the lake tower lobby complex, Ranchi's first "integrated building complex", as well as Ranchi, the city's most "happening" shopping mall and multiplex, Mr. P. Agrowal has emerged as the most sought after designer of some of the imaginative and striking landmarks on Kolkata's fast changing skyline. He is also the visionary designer for Kolkata's upcoming Raj Bhavan project in Bihar.



Kolkata, Kolkata's Most Modern Building, Agrowal & Agrowal

### Landscape Consultants

Design Accord Consultants, a multifaceted architectural design firm, has emerged as the convergence model for the three corners of design applications. They offer specialized services in Landscape, Interior & Product Design and Interiors.

Mr. Madhav Rajgopal  
Mr. Vinay Singh  
Design Accord Consultants  
12/19 Park Road, Green Island Road  
EPIP Development College, New Delhi - 110028  
E-mail: [madhavrajgopal@yahoo.com](mailto:madhavrajgopal@yahoo.com) & [designaccordconsultants@gmail.com](mailto:designaccordconsultants@gmail.com)



### Legal Advisors Saha & Ray, Advocates

Saha and Ray, Advocates, is one of the premier law firms specializing in real estate and property laws, with international affiliations that provide global terms of reference.

Mr. Anil Saha and Mr. Ajay Saha  
J&A's, Third Floor, Hooghly Chambers  
27/28 S. Ray Road, Kolkata 700005  
P: +91 (33) 2524433/2524434 F: +91 (33) 2524436 or [saharay.com](mailto:saharay.com)

## Our Promoters



Manoj K. Jain



Sanjay Jain



Vishal Kumar



CKS

[www.Zricks.com](http://www.Zricks.com)

Disclaimer: All information, figures and statistics in this brochure are subject to change without notice. Photographs used in this brochure are for illustrative purposes only and may not have been taken in actual promotional settings. The brochure is not a legal offering or document.

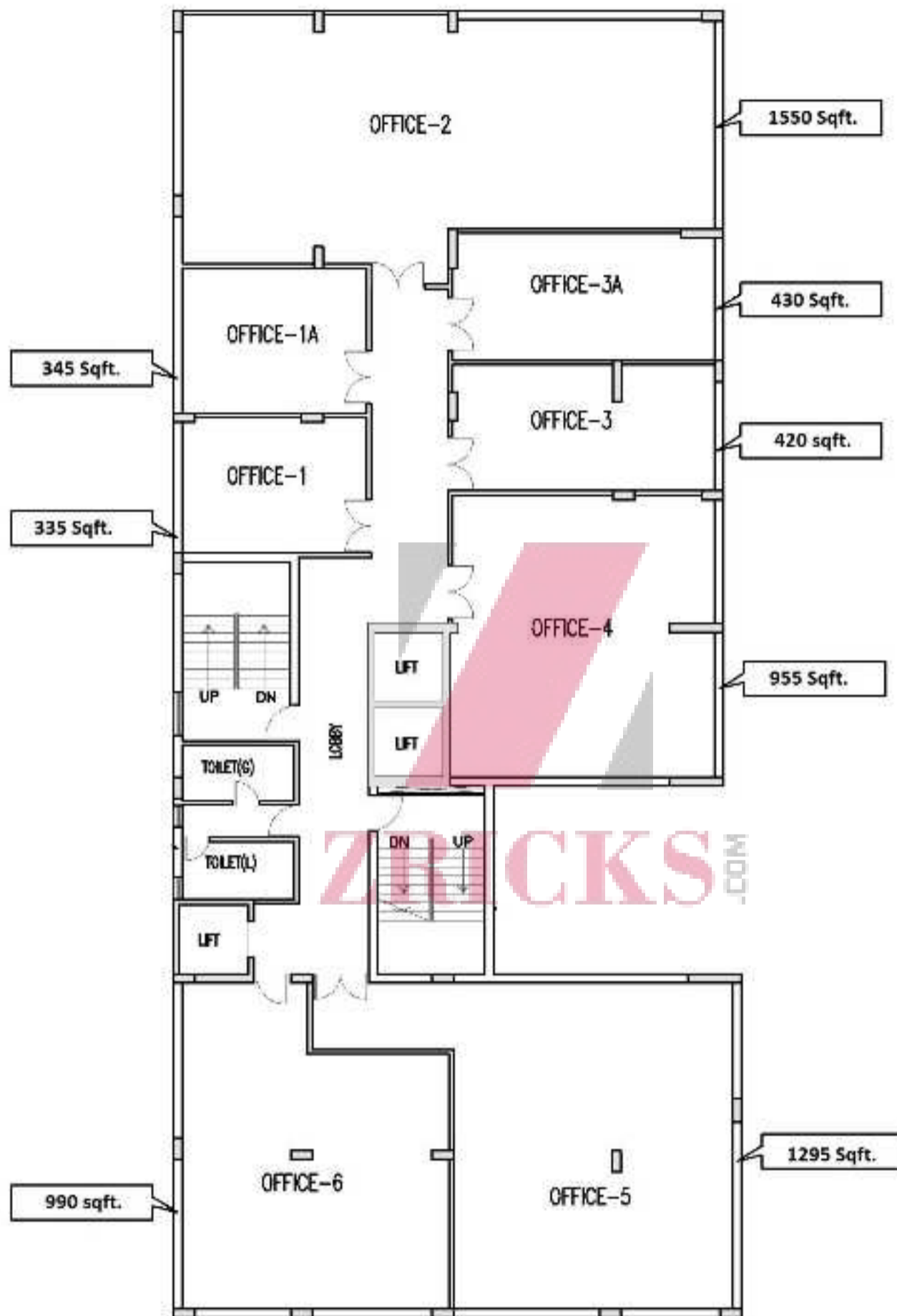

**2ND FLOOR PLAN  
(COMMERCIAL)**

PROJECT :-

**SIDDHA PINES - SILVER BLOCK**

NORTH



**BLOCK 1**



**FIRST FLOOR PLAN  
(COMMERCIAL)**

PROJECT :-

**SIDDHA PINES - SILVER BLOCK**

NORTH



**BLOCK 1**

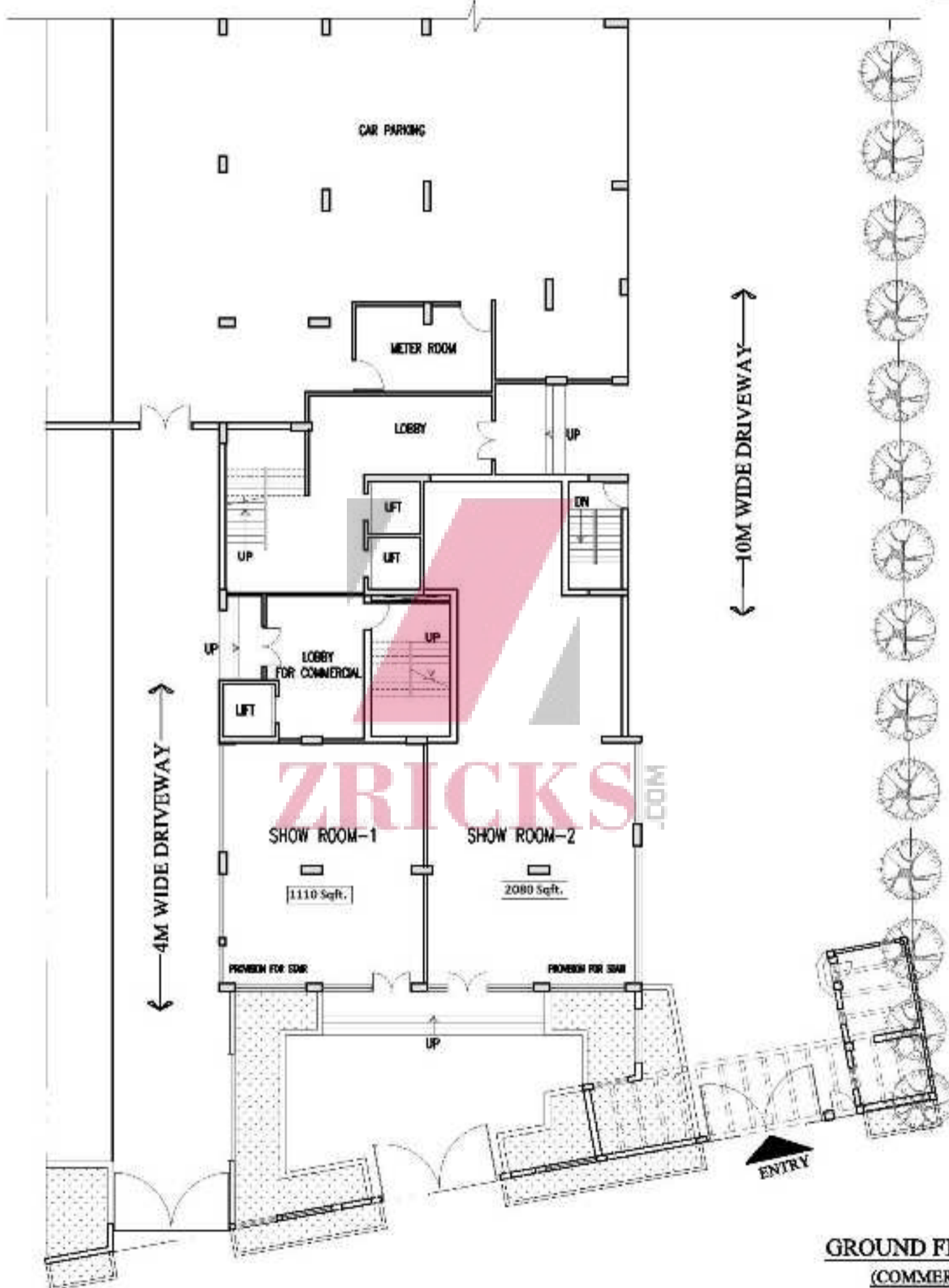

**GROUND FLOOR PLAN**  
**(COMMERCIAL)**